

<h1>TRAVEL GLIDE REMOVAL INSTRUCTIONS</h1>	<b>FURNITURE IS HEAVY, MOVING OR LIFTING SHOULD NOT BE ATTEMPTED ON YOUR OWN</b>
--	--

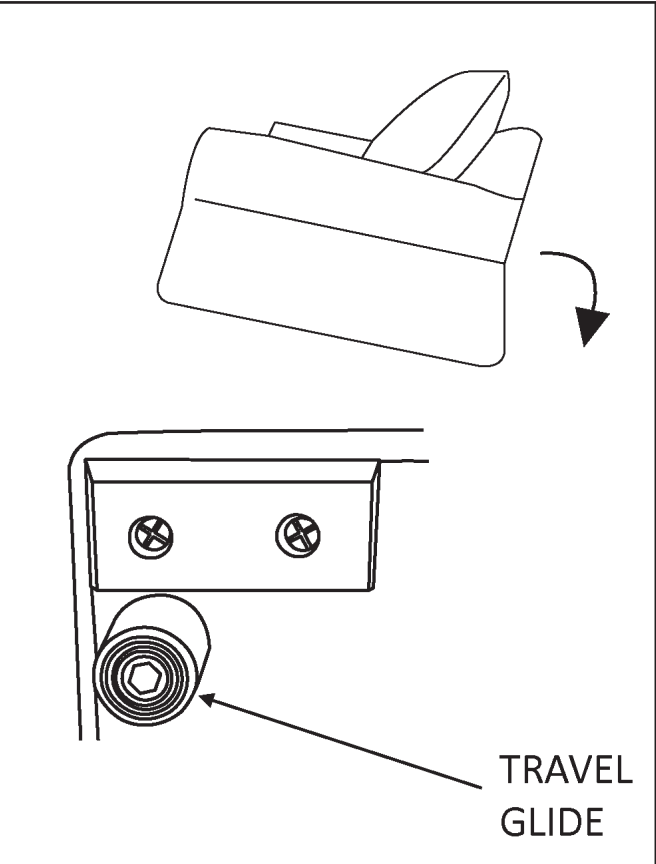

1. Gently turn your product onto its back. Locate the travel glides directly behind the wooden feet, only these glides should be removed.

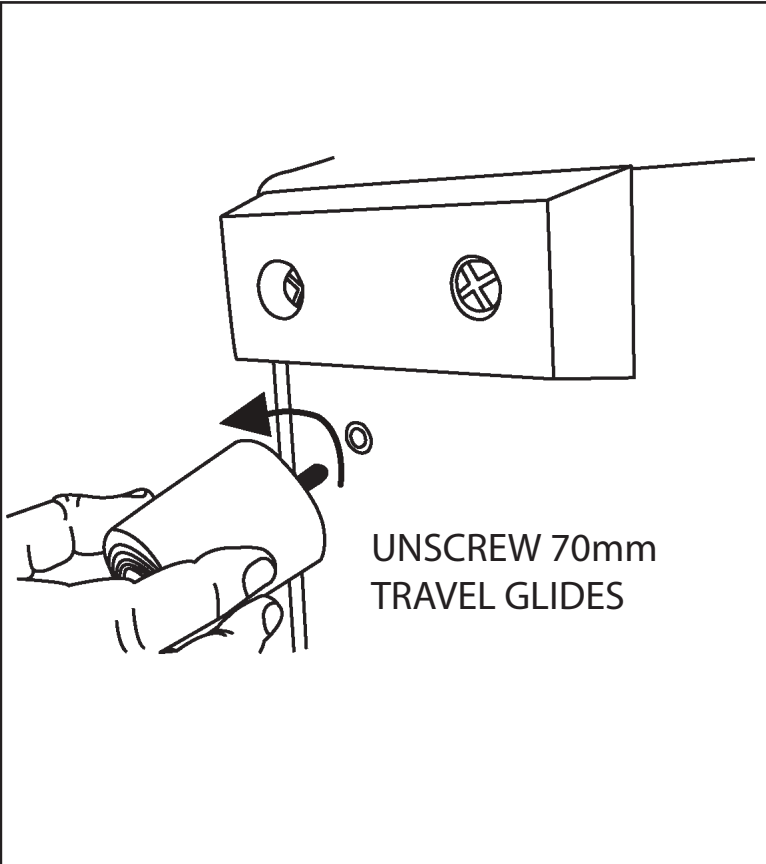

2. Unscrew the 70mm travel glides by turning anti-clockwise and remove.

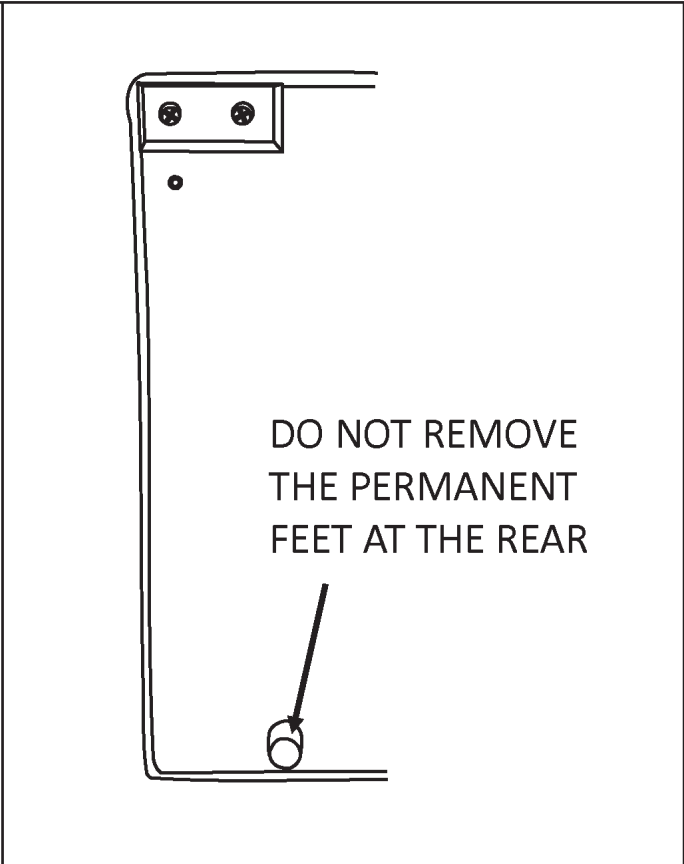

3. Be sure to leave the other smaller, hidden glides at the rear, as these are used as feet. Remove only the travel glides located next to the wooden feet.

PLEASE NOTE, IF YOU HAVE A WOODEN OR LAMINATE FLOOR, WE WOULD ADVISE YOU TO TAKE STEPS TO PROTECT YOUR FLOOR FROM POTENTIAL SCRATCHES AND MARKS. THE EASIEST WAY IS TO PLACE PROTECTIVE PADS UNDER THE FEET OF YOUR UPHOLSTERED FURNITURE TO PREVENT MARKS BEING MADE, OR PLACE THE UPHOLSTERED FURNITURE ON TOP OF A PROTECTIVE COVER SUCH AS A RUG. THE MANUFACTURER CANNOT BE HELD RESPONSIBLE FOR DAMAGE SUBSEQUENTLY CAUSED TO YOUR FLOORING BY NOT TAKING THE PREVENTATIVE MEASURES.

# TRAVEL GLIDE REMOVAL INSTRUCTIONS

## PERMANENT GLIDES & TRAVEL GLIDES

FURNITURE IS HEAVY, MOVING OR LIFTING  
SHOULD NOT BE ATTEMPTED ON YOUR OWN

- KEEP HIDDEN GLIDES  
(THESE ARE TO SERVE AS FEET)

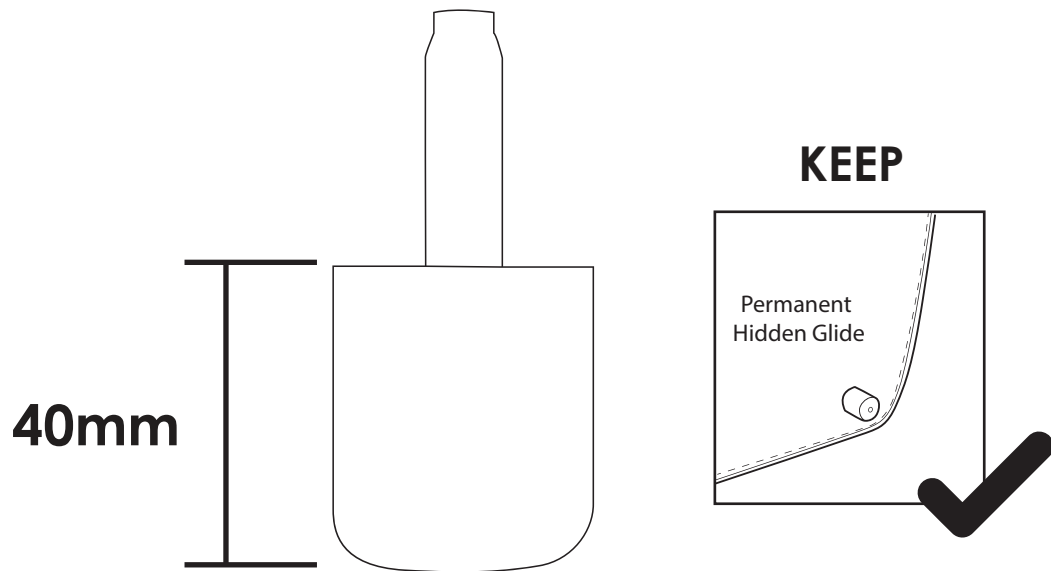

- REMOVE ALL TRAVEL GLIDES

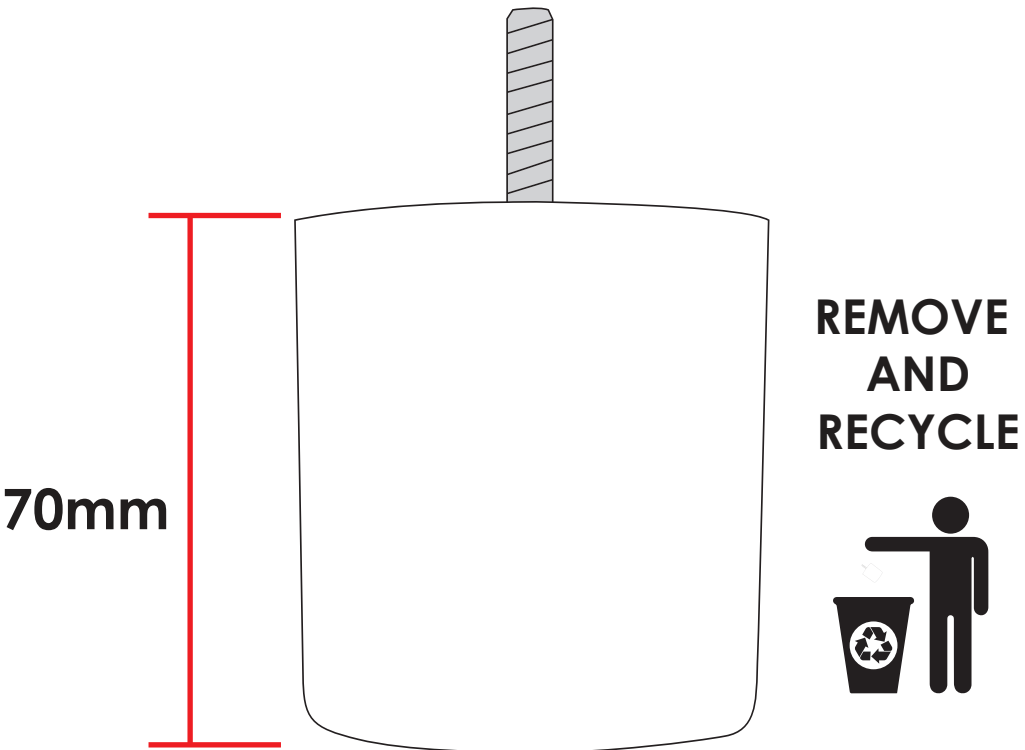

Example of 3  
Seater Sofa with  
fitted front feet.

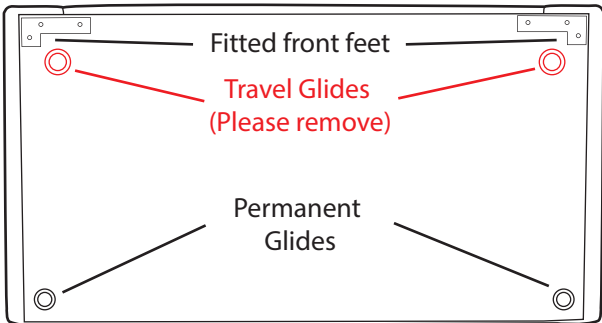

Example of 3 Seater  
Sofa with fitted front  
and back feet.

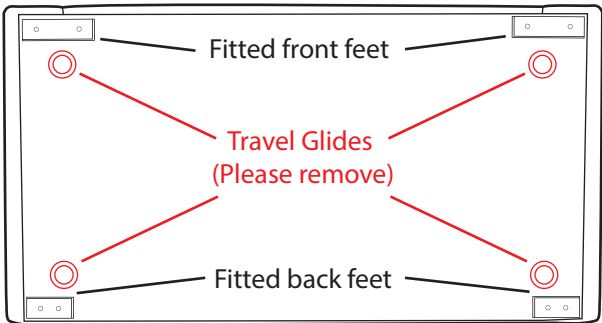

PLEASE NOTE, IF YOU HAVE A WOODEN OR LAMINATE FLOOR, WE WOULD ADVISE YOU TO TAKE STEPS TO PROTECT YOUR FLOOR FROM POTENTIAL SCRATCHES AND MARKS. THE EASIEST WAY IS TO PLACE PROTECTIVE PADS UNDER THE FEET OF YOUR UPHOLSTERED FURNITURE TO PREVENT MARKS BEING MADE, OR PLACE THE UPHOLSTERED FURNITURE ON TOP OF A PROTECTIVE COVER SUCH AS A RUG. THE MANUFACTURER CANNOT BE HELD RESPONSIBLE FOR DAMAGE SUBSEQUENTLY CAUSED TO YOUR FLOORING BY NOT TAKING THE PREVENTATIVE MEASURES.